

modern living collection



Fjords[®]

Relaxation Made Beautiful

Quick Ship Program Inventory Info: <http://www.fjords-usa.com/inventory-report/>



The ambition was to create a contemporary design with unrivalled seating comfort. The dual motorized design provides continuous support for your legs and back, with independent control of the footrest and back position, with bases which swivel. Available in all our leathers, Axel features a moveable head pillow for added comfort, and a manual release adjustable headrest angle. The chair is available in two sizes, medium and large.



SL Ice



SL Shadow Grey

Fjords Axel Measurements

Item	Width	Height	Depth	Seat Height	Seat Depth
Axel Medium	30.5"	40.5"	36"	18.5"	21"
Axel Large	32.5"	42"	37"	18.5"	22"

The Fjords Axel is available in a variety of fabric and leather options.

It is part of our quick ship program in Soft Line leather: Ice, Shadow Grey.



The ambition was to create a contemporary design with unrivalled seating comfort. The dual motorized design provides continuous support for your legs and back, with independent control of the footrest and back position, with bases which swivel. Available in all our leathers, Bo features a height adjustable headrest for added comfort, and a manual release adjustable headrest angle. The chair is available in two sizes, medium and large.



AL Slate
with Charcoal



AL Cement
with Charcoal

Fjords Bo Measurements

Item	Width	Height	Depth	Seat Height	Seat Depth
Bo Medium	31"	40.7"	34.7"	18.2"	21"
Bo Large	33"	44.2"	35.5"	19"	21.7"

The Fjords Bo is available in a variety of fabric and leather options.

It is part of our quick ship program in AL Slate with Charcoal, AL Cement with Charcoal.



Fjords®

Relaxation Made Beautiful

Fjords Finn

Modern Living Collection



The ambition was to create a contemporary design with an unrivalled seating comfort. The dual motorized design provides continuous support for your legs and back, with independent control of the footrest and back position, with bases which swivel. Available in all our leathers, Finn features a slim, classic modern look with a manual release adjustable headrest. The chair is available in two sizes, medium and large.



SL Pure White



SL Black

Fjords Finn Measurements

Item	Width	Height	Depth	Seat Height	Seat Depth
Finn Medium	34.3"	40"	36.2"	16.9"	19.7"
Finn Large	36.2"	42.9"	37"	17.7"	20.5"

The Fjords Finn is available in a variety of fabric and leather options.

It is part of our quick ship program in Soft Line leather: Pure White, Black



A contemporary design with an unrivaled seating comfort. The dual motorized design provides continuous support for your legs and back, with independent control of the footrest and back position, with bases which swivel. Available in all our leathers, Jakob features a slim, classic modern look with a manual release angle and height adjustable headrest. The chair is available in two sizes, medium and large.



SL Chili



SL Storm

Fjords Jakob Measurements

Item	Width	Height	Depth	Seat Height	Seat Depth
Jakob Medium	30.7"	41.3"	33.9"	18.9"	20.9"
Jakob Large	32.6"	43.3"	34.6"	18.9"	21.6"

The Fjords Jakob is available in a variety of fabric and leather options.

It is part of our quick ship program in Soft Line leather: Chili and Storm



A contemporary design with an unrivaled seating comfort. The dual motorized design provides continuous support for your legs and back, with independent control of the footrest and back position, with bases which swivel. Available in all our leathers, Magnus features a slim, classic modern look with a manual release angle and height adjustable headrest. The chair is available in two sizes, medium and large.



SL Shadow Grey



SL Cigar

Fjords Magnus Measurements

Item	Width	Height	Depth	Seat Height	Seat Depth
Magnus Medium	30.7"	41.3"	33.9"	18.9"	20.9"
Magnus Large	32.6"	43.3"	34.6"	18.9"	21.6"

The Fjords Magnus is available in a variety of fabric and leather options.

It is part of our quick ship program in Soft Line leather: Shadow Grey, Cigar



The ambition was to create a contemporary design with an unrivalled seating comfort. The dual motorized design provides continuous support for your legs and back, with independent control of the footrest and back position, with bases which swivel. Available in all our leathers, Oskar features a slim, classic modern look with wood base, and a manual release adjustable headrest. The chair is available in two sizes, medium and large.



AL Tabasco
with Espresso



AL Martini Olive
with Charcoal

Fjords Oskar Measurements

Item	Width	Height	Depth	Seat Height	Seat Depth
Oskar Medium	31.1"	39.8"	35.8"	18.1"	21.7"
Oskar Large	33.5"	42.2"	35.5"	19"	22.5"

The Fjords Oskar is available in a variety of fabric and leather options.

It is part of our quick ship program in AL Tabasco with Espresso and AL Martini Olive with Charcoal.

Our warranty service provides the ordering and shipping of replacement components as noted:

10-years warranty -

Frames: 10 years for the metal frame and all steel mechanical functions. Classic Comfort Collection, and Norsk Collection only.

5-years warranty -

Molded Foam, Wood components, Plastic components, Gas Cylinders and all Cables. Molded cushions are warranted against collapsing for a period of 5 years. Loss of foam resiliency should not be confused with softening of foam which results from normal wear and tear.

3-years warranty -

Swing Relax Collection and Modern Living Collection reclining mechanisms and power components.

2-years warranty -

Leather or fabric covers.

- i. This is not an unlimited warranty.
- ii. For fabric: this is a warranty against pilling or wear through only.
- iii. For leather: this is a warranty against wear through or tearing only. It does not warrant against soiling, especially soiling caused by sweat and other body fluids.
- iv. It does not warrant against fade or color loss.

1-year warranty -

Battery for Modern Living Collection.

Notes. Consumer must go through purchasing dealer for any warranty claims. In almost every case, Fjords/Hjellegjerde USA will replace or repair any component that has failed that is under warranty. Only in the most unusual of circumstances will we consider replacing the whole product.

Note: Fjords products have a tested load capacity of 250 pounds under our warranty.

The option to replace the whole product rests solely upon Fjords/Hjellegjerde.



Fjords®

Relaxation Made Beautiful

Modern Living Collection Battery Information

KS RC-Battery-Pack MC 463 (item no. 001 06 00008 04)



MC172 - 502349 US-Version item no.: 001 06 10010 04



Extension Cable 502268 item no.: 001 06 00019 04

FEATURES AND BENEFITS

- Battery will be supplied with approximately an 80% pre-charge.
- Battery can be stored for up to 18 months.
- Smart controller checks the status of each of 5 battery cells regularly.
- If power level falls below 30%, it will beep, reminding the user to recharge the battery.
- Control panel on the side of the chair will illuminate to **RED** when battery level falls below 30%.
- When battery is in regular use, it is recommended to recharge every 3 months.
- When battery is fully charged, the control panel on chair will illuminate **GREEN** when in use.

SLEEP MODE FUNCTION

- Sleep Mode gets activated automatically when power level falls to below 20%.
- The Sleep Mode Safety Feature prevents the battery from completely draining which would destroy the battery cells and prevent it from charging.
- If chair falls into sleep mode, the chair will cease to operate until the battery is fully charged to 100% capacity (approximately 8 hours).

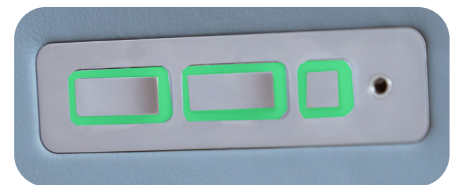

Green lights on the control panel indicate a battery that is fully charged.

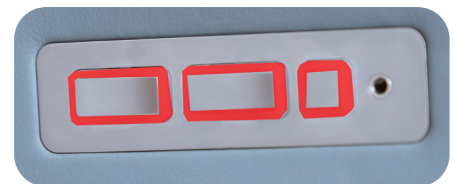

Red lights on the control panel indicate that battery level is below 30% and must be recharged before it enters SAFE MODE. An auditory BEEP will also sound.



Fjords®

Relaxation Made Beautiful

Modern Living Collection Battery Information

CHARGING THE BATTERY

- Modern Living Recliners come pre-wired to charge the battery. Simply plug the adaptor into the Battery Charging Portal.
- The battery comes pre-charged at 80% capacity.
- When battery life reaches 30% it will beep and operating controls will illuminate Red.

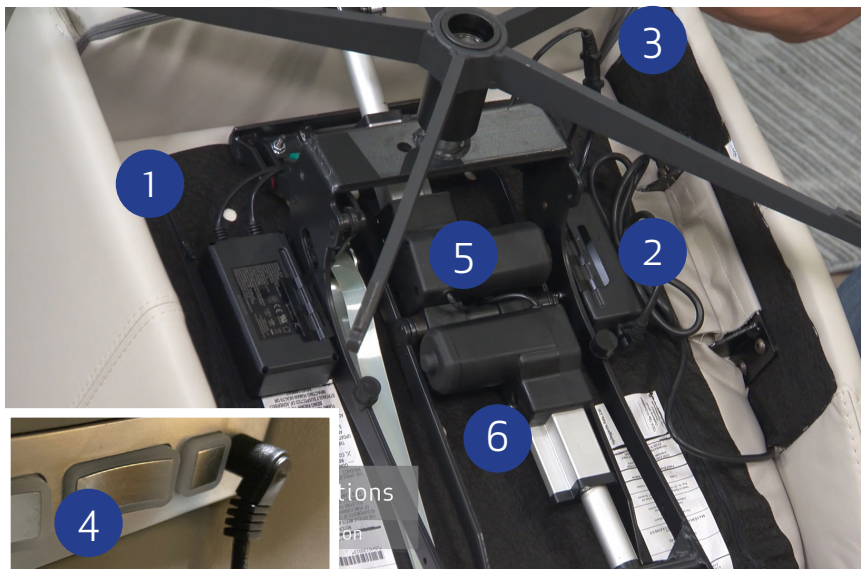

MOTORS AND WIRING FOR MODERN LIVING RECLINERS

1. Lithium Battery
2. Internal Transformer
3. Connect / Disconnect Battery and Operate with Direct Power. NOTE: When you disconnect the battery and go direct power, you will no longer be charging the battery, even when plugged into wall.
4. Battery Charging portal (outside of chair)
5. Motor for backseat
6. Motor for footrest

Direct Power

Batteries will eventually wear out. To order a new battery, simply contact the selling dealer. If that happens, Modern Living Recliners also come with a direct power option. Simply disconnect the battery and plug in the wall adaptor as shown below. NOTE: This method by-passes the battery. As a result, the battery will not charge if you are operating direct power.

